



Kansas FCCLA Take AIM Conference

August 25-26, 2024 | KSU Union



EVENT SCHEDULE

Sunday, August 25

12:00 – 3:00 pm	State Officer Meeting	Big 12 Room
12:00 – 2:00 pm	District President Meeting w/ Emma DeMaranville	Flint Hills Room
12:00 – 2:00 pm	Peer Education Team meeting	Cottonwood Room
1:00 pm	Registration open	Concourse
	A & A Sales open	Concourse
	Red Blazers can be turned in	Concourse
2:00 – 3:30 pm	District Meetings	
	District A	Room 224 – Muir (N)
	District B	Flint Hills Room
	District D	Room 224 – Muir (S)
	District EE (officers only)	Room 209
	District EW	Room 207
	District F	Room 206
	District G (officers only)	Room 208
	District H	Cottonwood Room
	District JW	Room 227
2:30 – 3:30	Willie the Wildcat appearance & Call Hall Ice Cream	Concourse
3:30 – 5:00 pm	Opening Member Session - Teambuilding/Leadership	Grand Ballroom
3:30 – 5:00 pm	Adviser Session	Big 12 Room
	Welcome - Heather Corley & Shandi Andres	
	Kansas FCCLA Alumni & Associates Update, LEO's	
	Kansas FCCLA Educational Foundation	
	KATFACS	
	KAFCS	
	Adviser - to - Adviser Sharing - Jen Carder & Megan Mein	
5:00 – 6:30 pm	Dinner on your own	
6:30 – 8:40 pm	Member Round Tables & Community Service Opportunity	Round Tables -
	6:30 – 7:10 Rotation 1 (Group 1 - Community Service; 2&3 - round tables)	Grand Ballroom
	7:15 – 7:55 Rotation 2 (Group 2 - Community Service; 1&3 - round tables)	
	8:00 – 8:40 Rotation 3 (Group 3 - Community Service; 1&2 - round tables)	Community Service -
		Cottonwood &
		Flint Hills Rooms
	Community Service Project	
	Operation Gratitude for Military Family Members	
	Round Table Topics	
	8 minutes at a round table, begin at the :10 increments	
	Running for a National Office - Ava Gustin	
	Running for a State Office - Madison Givens	
	Running for a District Office - Emily Sobba & Danika Metcalfe	
	Running for Peer Ed - Emma Struttman	

Chapter Fundraiser - Jaden & Aubrey, Mission Valley
 FACTS National Program
 Elevating PR for your Chapter - Brandt Smith
 STAR Events Process - Aly Young
 LEO's - Alex Wulfkuhle
 Creating an Attitude of Gratitude - Madelyn Schiltz
 Awards, Scholarship, & Opportunities - Easton Hrabe
 Community Service National Program - Taegan Shannon
 State Community Service Project - Kendra Conrad
 FCCLA 101
 Chapter Ideas for Engagement
 STAR Event Demonstration

6:30 - 8:40 pm Adviser Session Big 12 Room
 Upcoming Events
 Kansas FCCLA Update
 Competitive Event Update & Demos

9:00 - 11:00 pm Foundation Event
 Shoes and bowling included

Round Tables & Community Service Groups – Sunday, August 25

Group 1		Group 2		Group 3	
Black	Pink	Gray	Blue	White	Lavender
Campus	Jackson Heights	Lebo/Waverly	Wabaunsee	SE of Saline	Valley Falls
Anderson Co.	Altoona-Midway	Hutchinson	Herington	Frankfort	Cimarron
Fredonia Jr	El Dorado	Holton	Lakeside	Wichita N	Yates Center
Abilene	Bonner Springs	Caney Valley	Gardner-Edgerton	El-Saline	Crest
Humboldt	St. Marys	South Gray	Solomon	Neodesha Sr	Neodesha Jr
Northern Heights	Olathe NW	Manhattan	Piper	Pittsburg	Plainville
Hoxie	Phillipsburg	Jefferson West	Goodland	Hill City	Hoisington
Triplains	SHS	Clearwater	Goessel	Horton	Macksville
Washington Co.	West Elk	Ottawa	Republic Co.	Royal Valley	Wichita Heights
SW Heights	Kingman	Victoria	Satanta	Liberal	Paola
Chapman	Fredonia Sr	Dodge City	Ellis	Trego/Wakeeney	Stockton
Chanute High	Smith Center	Independence HS	Basehor-Linwood	Central Heights	Iola
Lansing	Mission Valley	Girard	Oakley	Oswego	Rossville
Blue Valley Rand.					Tonganoxie

Monday, August 26

7:30 am - 12:00 A & A Sales open

8:00 am - 12:00 **Member Workshop Sessions**

choose topics that interest you for each of the 5 rotations

Rotations:	Trooper Todd about Traffic Safety, FACTS Peer Ed Team	Flint Hills Room
1) 8:00 - 8:40	The BEST You - presented by Student Body Peer Ed Team	Cottonwood Room
2) 8:50 - 9:30	Positive Friends, Positive Lives, Career Connection Peer Ed Team	K Ballroom
3) 9:40 - 10:20	Kicking Off Community Service, Community Service Peer Ed Team	S Ballroom
4) 10:30 - 11:10	STAR Events Process - Madison Givens	U Ballroom
5) 11:20 - 12:00	How to Run for a District Office - Taegan Shannon & Kendra Conrad	Muir Room
	How to Run for State Office - Ava Gustin	Room 209
	Chapter Fundraising - Funding Our Why - Madelyn Schiltz	Room 227
	Elevate Your Chapter's Public Relations: Embrace the Power of Big Dreams - Easton Hrabe & Brandt Smith	Room 207

8:00 am - 12:00	Adviser Workshop Sessions	Big 12 Room
	KSDE FCS Consultant Update	
	Portal & Website Info	
	Awards	
	Bylaws & Procedure Manual	
	Adviser Sharing - Chapter Management, Resources, Fundraising, National Program Ideas	

Door Prizes

MAP - 2nd floor of KSU Union

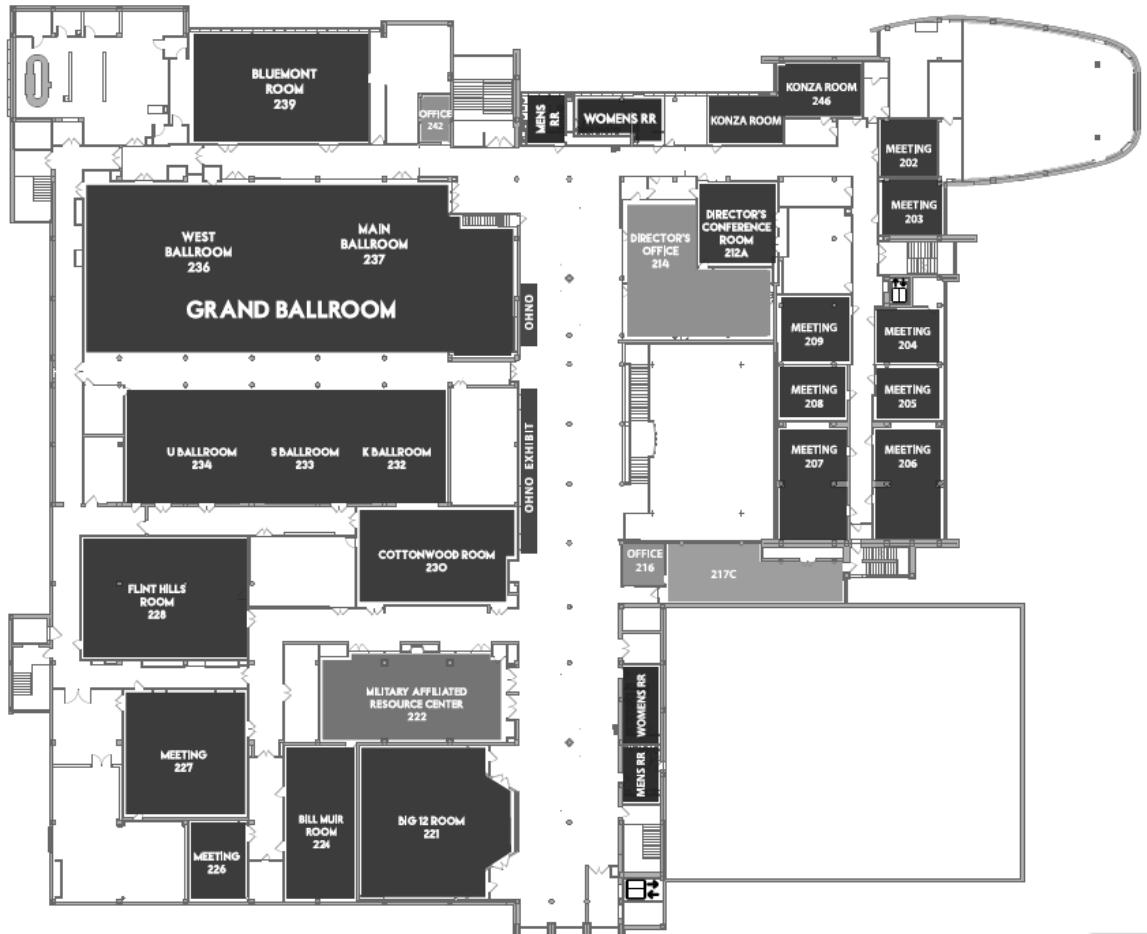

2024-2025 LEADERSHIP

2024-2025 Kansas FCCLA State Executive Council

President - Ava Gustin
1st Vice President - Easton Hrabe
VP of Individual Program - Madison Givens
VP of Recognition - Taegan Shannon
VP of Peer Education - Kendra Conrad
VP of Public Relations - Brandt Smith
VP of Corporate Relations/Finance - Madelyn Schiltz
State Adviser - Shandi Andres

2024-2025 District Presidents

District A	Leigha Hilgers - Trego	District F	Keagan Showalter - South Gray
District B	Saige Moos - Victoria	District G	Christina Wingo - Southeast of Saline
District C	Karizma Matthews - Herington	District H	Landon McDaniel - Fort Scott
District D	Garrett Hill - Washington	District I	Hannah Schauf - Clearwater
District EE	Huston Alber - Tonganoxie	District JE	Delanie Roblyer - Girard
District EW	Elli Asher - Rossville	District JW	Reghan Ervin - West Elk

2024-2025 Peer Education Teams

Peer Education Coordinator - Heather Corley

Community Service

Merenda Bennett - Mission Valley
Taegan Ross - Mission Valley
Taryn Clark - Mission Valley
Easton Hanson - Council Grove

Student Body

Harlee Morando - Tonganoxie
Aubrey Padfield - Tonganoxie
Kipra Reed - Southeast of Saline
Brooklynn Schmelzle - Valley Falls

FACTS

Aurora Nowlin - Victoria
Ruby Gomel-Osthoff - Smith Center
Arlis Thurman - Hoisington

Career Connection

Hazel Estes - Fredonia
Jayla Bunyard - Fredonia
Emma Struttman - Anderson County
Aly Young - Anderson County
Adrian Hess - Anderson County